





## SAVE THESE INSTRUCTIONS

### TROUBLESHOOTING

There are several things to look for if your trimmer fails to operate:

1. Be sure the trimmer is turned ON.
2. Make sure that the battery is properly placed in the battery compartment. Test the battery to be sure it is working.
3. Check the blades to see if they are clogged with hair clippings; if so, use a cleaning brush to remove hair.
4. If the trimmer still fails to operate, take or send it to a Conair Service Center (see warranty procedure and addresses).

### FOR HOUSEHOLD USE ONLY

## OPERATING INSTRUCTIONS

1. Remove the battery cover at the back of the unit by pulling straight down. (Fig.1)
2. Being careful not to bend the clips, insert the negative end of the battery first, so it will slip easily into position.
3. Return the battery cover to its original position by pushing it into place.
4. To use your trimmer, push ON/OFF switch upwards to ON position.

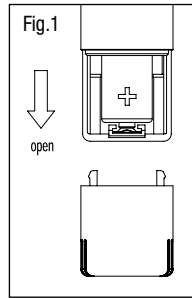

Fig.1

open

## GUARDE ESTAS INSTRUCCIONES

### RESOLUCIÓN DE PROBLEMAS

Si su aparato no funciona correctamente:

1. Asegúrese de que el aparato esté encendido.
2. Asegúrese de que la pila esté debidamente instalada. Cerciúrese de que la pila no está agotada.
3. Revise las cuchillas y límpielas si fuera necesario, usando el cepillo de limpieza provisto.
4. Si esto no soluciona el problema, regrese el aparato a un centro de servicio autorizado (véase la información de garantía).

## PARA USO DOMÉSTICO SOLAMENTE INSTRUCCIONES DE OPERACIÓN

1. Para instalar la(s) pila(s) abra el compartimiento de la(s) pila(s) ubicado en la parte trasera del aparato. (Fig.1)
2. Introduzca el polo negativo primero, teniendo cuidado de no doblar las patas de contacto.
3. Cierre el compartimiento de la(s) pila(s).
4. Para encender el aparato, deslice el interruptor hacia arriba (ON).

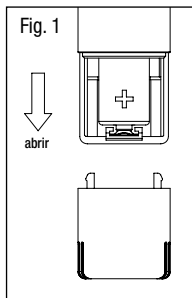

Fig. 1

abrir

5. After you finish using your trimmer, push down on the ON/OFF switch to turn the trimmer off.
6. Always purchase the correct size and grade of battery most suitable for the intended use.
7. Replace the battery once it is no longer functional.
8. Clean the battery contacts and also those of the devise prior to battery installation.
9. Ensure the batteries are installed correctly with regard to polarity (+ and -).
10. Remove batteries from equipment, which is not to be used for an extended period of time.
11. Remove used batteries promptly.
12. Store unused batteries in their original packaging, away from metal objects that could short-circuit them. Never short-circuit batteries.
13. Never dispose of batteries in fire, except under conditions of controlled incineration. Failure to observe this precaution may result in an explosion. Never attempt to recharge primary batteries as this may cause leakage, fire, or explosion.

**\*Both trimmers require 1 "AA" battery (not included).** We recommend using alkaline batteries in your trimmers because they last longer. If you are not going to use your trimmers for a long period of time, or if the battery is dead, remove the battery from the unit. This will increase the life of your trimmers.

### TO TRIM NECKLINE & SIDEBURNS

Using the detail trimmer, hold the trimmer blade against the skin at the length desired and move the trimmer downward.

### TO TRIM YOUR FACIAL HAIR

To shape and define, move the detail trimmer slowly so as not to cut any hair you do not intend to trim.

### TO TRIM NOSE HAIR

Gently insert the nose/ear trimmer into nostril. Gently move trimmer in and out of the nostril to remove unwanted hair. Avoid inserting the trimmer more than 1/4" to ensure safe trimming.

### TO TRIM EAR HAIR

Gently insert the nose/ear trimmer no more than 1/4" into outer ear canal. Gently move trimmer around the outer ear to remove unwanted hair extending beyond the outer ear. Guide the trimmer around the outer surface of ear to trim protruding hairs. Never insert trimmer more than 1/4" into ear canal.

### TAKING CARE OF YOUR TRIMMER

#### BLADE CARE

Because the trimmer blades are precision made for a very special use, they should always be handled with care. Each time you finish using the trimmer, take a cleaning brush and brush away any loose hair that has collected in the blades.

#### TO CLEAN YOUR TRIMMER

Make sure trimmer is off.

1. To remove the trimmer head for cleaning, turn the head counter-clockwise until the "I" mark aligns with the "arrow" mark, then lift the head gently (Fig. 1).

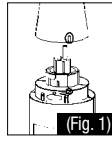

(Fig. 1)

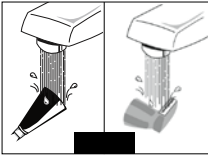

2. Only rinse the head under water (Fig. 2). For proper functioning of the unit, the handle can not touch or be immersed in water.

3. After cleaning, make sure to shake dry the head before replacing it to the body.

4. To reassemble the head onto the body, align the "I" mark on the head with the "arrow" mark on the body and then turn clockwise until the "I" mark aligns with the "circle" mark on the body (Fig.3).

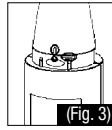

(Fig. 3)

### NOSE/EAR TRIMMER & DETAIL TRIMMER



Removable trimmer head

On/Off switch

Battery compartment



Removable trimmer head

On/Off switch

Battery compartment

### CORTAPELO PARA NARIZ/OREJAS & RECORTADORA



Cabezal de quita y pon

Botón de encendido/apagado

Compartimiento de la(s) pila(s)



Cabezal de quita y pon

Botón de encendido/apagado

Compartimiento de la(s) pila(s)

### TWO YEAR LIMITED WARRANTY

Conair will repair or replace (at our option) your unit free of charge for 24 months from the date of purchase if the appliance is defective in workmanship or materials.

To obtain service under this warranty, return the defective product to the service center listed on the back, together with your purchase receipt and \$3.00 for postage and handling. California residents need only provide proof of purchase and should call 1-800-366-0937 for shipping instructions. In the absence of a purchase receipt, the warranty period shall be 24 months from the date of manufacture.

**ANY IMPLIED WARRANTIES, OBLIGATIONS, OR LIABILITIES, INCLUDING BUT NOT LIMITED TO THE IMPLIED WARRANTY OF MERCHANTABILITY AND FITNESS FOR A PARTICULAR PURPOSE, SHALL BE LIMITED IN DURATION TO THE 24-MONTH DURATION OF THIS WRITTEN, LIMITED WARRANTY.** Some states do not allow limitations on how long an implied warranty lasts, so the above limitations may not apply to you.

**IN NO EVENT SHALL CONAIR BE LIABLE FOR ANY SPECIAL, INCIDENTAL, OR CONSEQUENTIAL DAMAGES FOR BREACH OF THIS OR ANY OTHER WARRANTY, EXPRESS OR IMPLIED, WHATSOEVER.** Some states do not allow the exclusion or limitation of special, incidental, or consequential damages, so the above limitation may not apply to you.

This warranty gives you specific legal rights, and you may also have other rights, which vary from state to state.

Please register this product at [www.conair.com/registration](http://www.conair.com/registration)

©2012 Conair Corp.  
**Service Center**  
Conair Corporation  
Service Department  
7475 North Glen Harbor Blvd.  
Glendale, AZ 85307

12PG129785

IB-11276

### CLIPPER, TRIMMER & NOSE/EAR DETAILER

3-in-1 kit

#### MULTI-PURPOSE

includes clipper, trimmer and nose/ear detailer for all your grooming needs



Instructions for Trimmer Care and Use  
Model HCT401

## CONAIR

HOME HAIRCUTTING KIT

### CORTADORA, RECORTADORA & CORTAPELO PARA NARIZ/OREJAS

3-en-1

#### MULTIUSO

Incluye una cortadora, una recortadora y un cortapeelo para nariz/orejas, para todas sus necesidades de corte de cabello y cuidado personal en casa.



Instrucciones de uso y mantenimiento  
Modelo HCT401

## CONAIR

JUEGO DE PELLUQUERÍA

Para registrar su producto, visítenos en: [www.conair.com/registration](http://www.conair.com/registration)

©2012 Conair Corporation  
**Centro de servicio**  
Conair Corporation  
Service Department  
7475 North Glen Harbor Blvd.  
Glendale, AZ 85307

12PG129785

IB-11276